

# EXPOSED TEE SYSTEM ACCESSORIES

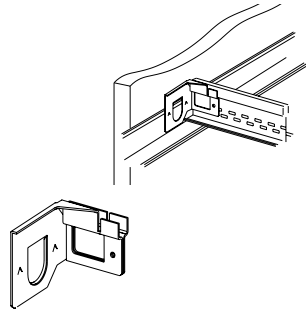

### BERC – Beam End Retaining Clip

Joins main beam or cross tee to wall molding and web of grid with no visible pop rivets

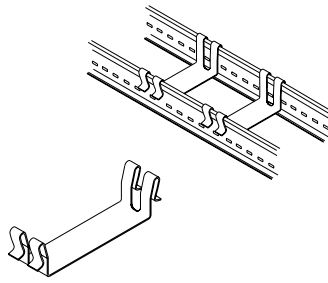

### ABSC – Air Bar Spacer Clip

Parallel attachment of main runners; evenly spaces grid members for air diffuser; available in sizes from 1-7/8" to 6" in 1/8" increments

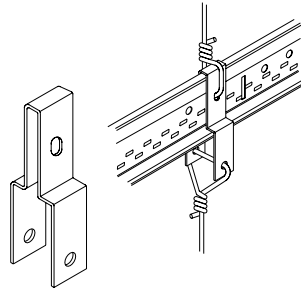

### DLCC – Direct Load Ceiling Clip

To hang suspension system below existing 15/16" grid face, transferring weight directly to hanger wire; may be used to preserve the fire rating of an existing ceiling and to support heavy accessories (consult local codes for requirements)

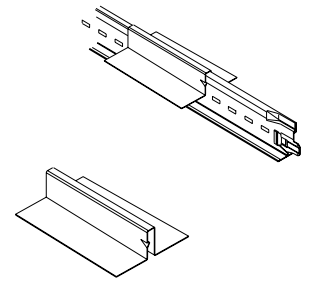

### EHC50 – Exterior Hold Down Clip for 1/2" lay-in ceiling panels and drywall

**EHC58 – Exterior Hold Down Clip for 5/8" lay-in ceiling panels and drywall**

**EHC75 – Exterior Hold Down Clip for 3/4" lay-in ceiling panels and drywall**

Locks under bulb of grid member to prevent upward movement; UL approved for Wind Uplift Classifications 15 and 90

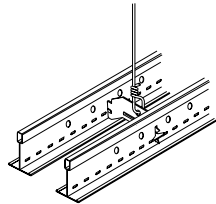
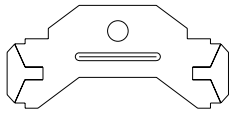

### MBSC2 – Main Beam Spacer Clip (2" in length)

Used to space two parallel main beams for air supply or return; typically used 4' O.C.

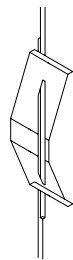

### WS12 – Hanger Wire Splice

Splices #12 gauge hanger wire; recommended for renovation applications; provides easy adjustment of ceiling height

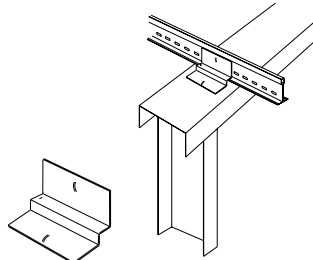

### UPC – Partition Clip

Fastens partition track section to grid for secure attachment; flip for 9/16" or 15/16" grid

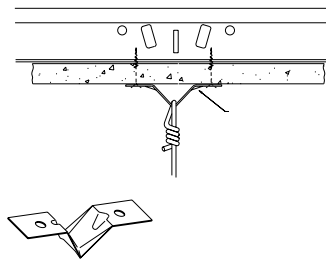

### DWC – Drywall Clip

Allows for a "second" ceiling to be installed below a drywall ceiling; attach through installed drywall to supporting structure

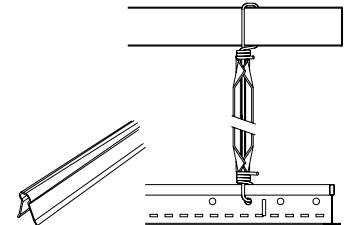

### 7872 – Stiffening Brace

Vertical attachment to hanger wire between grid and deck; holds suspension system in place during wind uplift and in high security areas; UL listed for Wind Uplift Classifications 15 and 90

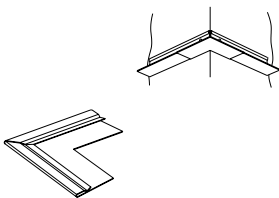

### 7863 – Outside Corner Cover

For nominal 7/8" angle molding; snap over molding to trim outside corners

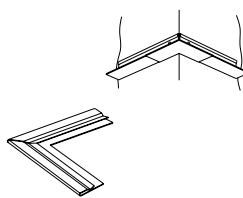

### 7865 – Outside Corner Cover

For nominal 9/16" angle molding; snap over molding to trim outside corners

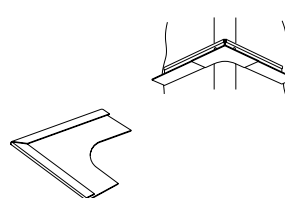

### 7866 – Bullnose Corner Cover

For nominal 15/16" molding; snap over molding to trim outside corners; fits 1" radius block

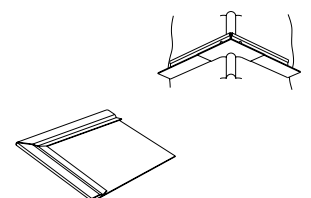

### 7867 – Field Cut Corner Cover

For nominal 15/16" molding; cut to fit irregular corner conditions

# EXPOSED TEE SYSTEM ACCESSORIES

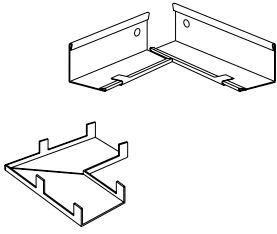

**7869 - Inside/Outside Corner Cover**  
For nominal 7/8" angle molding

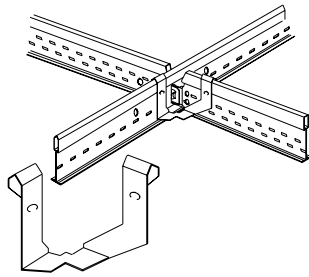

**LFC - Fixture Clip**  
Prefinished white for use at corners of light fixture modules on 9/16" exposed tee grid systems (Suprafine, Interlude, Silhouette); increases corner size to 15/16" which adapts light fixtures designed for 15/16" grid; used when fixtures are not positively attached to grid

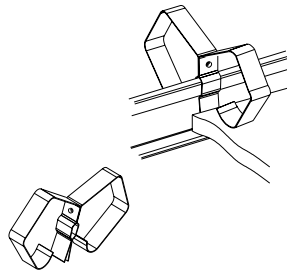

**414 - Retention Clip**  
Attaches to main beams and cross tees behind lay-in ceiling; helps prevent accidental panel displacement by basketballs and other forces from below ceiling

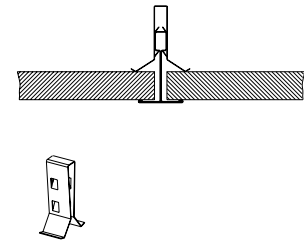

**UHDC - Universal Hold Down Clip**  
Clip attaches to top bulb of grid to hold 1/16" to 3/4" lay-in tile in place; helps to prevent ceiling tile fluttering at entryways

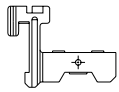

**C1430 - Variable Placement Hook Clip**  
Attach to T-bar to create special length tees and position anywhere along the main beams

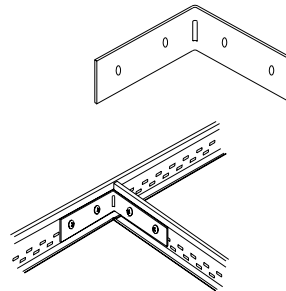

**7347 - 48" Variable Placement Hook over Cross Tee**  
**7327 - 24" Variable Placement Hook over Cross Tee**  
Attaches to Prelude 15/16" x 1-1/2" system by snapping over bulb of grid; provides flexibility to locate cross tees on main beams or cross tees to accommodate off module lights or diffusers and integrates with discontinued/competitive 15/16" grid systems

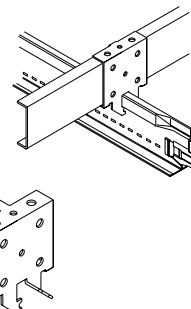

**XTAC - Cross Tee Adapter Clip**  
Used to attach field cut cross tees to main beams

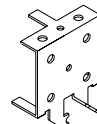

**UTC - Uptight Clip**  
For tight grid attachment to 1-1/2" channel; bridging under HVAC ducts; can be used to install grid tight to wood joists

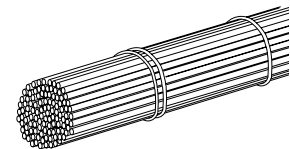

**7891 - 12 Gauge Super Soft Hanger Wire (12' length)**  
**7892 - 12 Gauge Soft Hanger Wire (12' length)**  
Used to hang suspended ceilings from structural deck

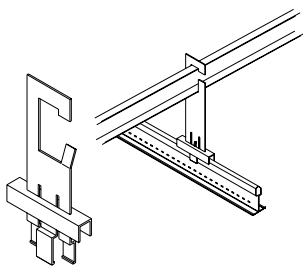

**CBS4 - 4" Channel Beam Splice**  
**CBS6 - 6" Channel Beam Splice**  
**CBS8 - 8" Channel Beam Splice**  
**CBS10 - 10" Channel Beam Splice**  
**CBS12 - 12" Channel Beam Splice**  
Used to suspend square bulb main beams to 1-1/2" black iron carrying channels

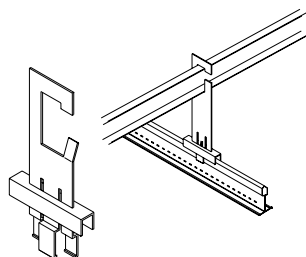

**CBS2006 - 6" Channel Beam Splice**  
**CBS2008 - 8" Channel Beam Splice**  
Used to suspend square bulb main beams to 2" black iron carrying channels

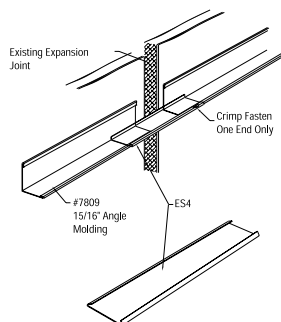

**ES4 - 4" Expansion Sleeve**  
For 15/16" main beams, cross tees and wall angle moldings; covers expansion joints, screw holes in grid face and main beam splice conditions